



## 136 President Avenue MIRANDA NSW

4 2 2

Conveniently positioned on a corner block (Calliope Road), this single level family home oozes potential and is on an impressive 796sqm (approximate) parcel of land.

**Type** : House

**View** : <https://www.burkeproperty.com.au/7404029>

Features are:

- Four well proportioned bedrooms - master with ensuite
- Separate lounge and dining areas
- Large modern kitchen
- Covered entertaining area
- Double garage with large workshop
- Lush level yard with side street access
- Short stroll to Westfield Miranda, schools and transport
- Easy walk to Camellia Gardens and Yowie Bay



**David Kennedy**  
02 9544 1111

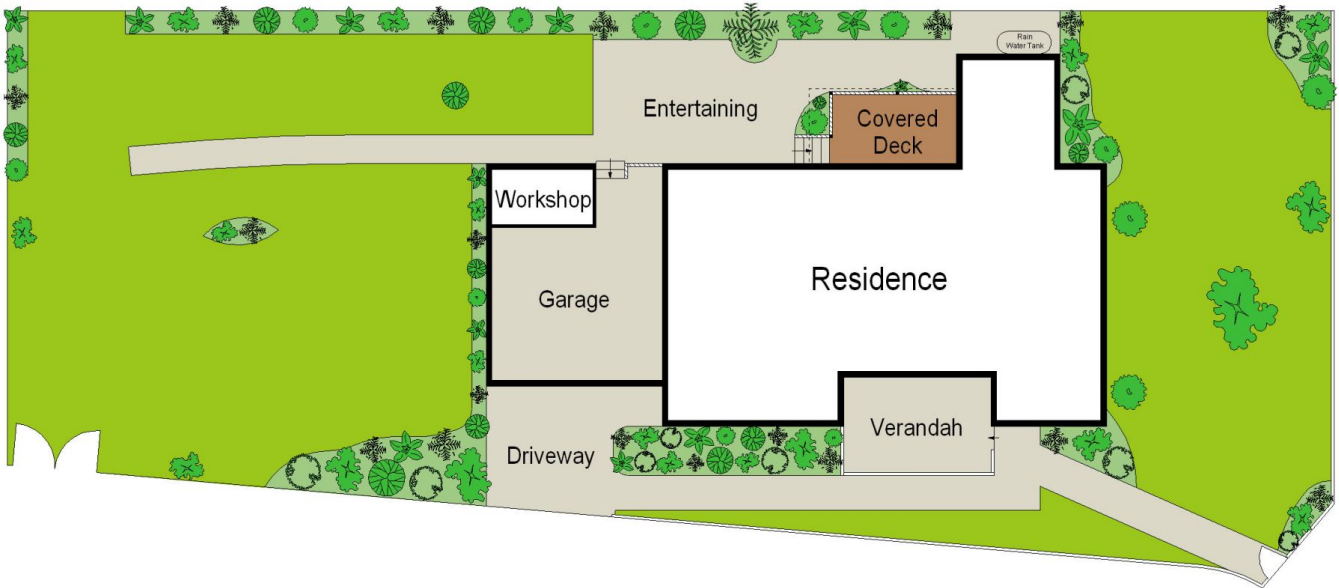

**SITE PLAN (NOT TO SCALE)**



**GROUND FLOOR**

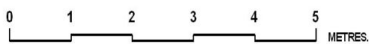

Scale in metres. Indicative only. Dimensions are approximate. All information contained herein is gathered from sources we believe to be reliable. However we cannot guarantee its accuracy and interested persons should rely on their own enquiries.



136 President Avenue, Miranda