



8/23-29 Hotham Road GYMEA NSW

3  2  3 

Ideally situated only a short walk to Gymea Village, this stylish light-filled north facing townhouse in a security complex offers a low maintenance relaxed lifestyle and convenience.

Features are:

- Double brick construction throughout
- 3 well proportioned bedrooms with built-in robes
- Master with ensuite
- Modern bathroom
- Quality kitchen with Caesarstone bench tops, dishwasher and gas cooktop
- Breakfast area/study nook
- Spacious tiled living with double doors
- Sundrenched north facing courtyard

**Type** : Townhouse

**View** : <https://www.burkeproperty.com.au/7404102>



**David Kennedy**  
02 9544 1111

[For full version visit the website](https://www.burkeproperty.com.au)

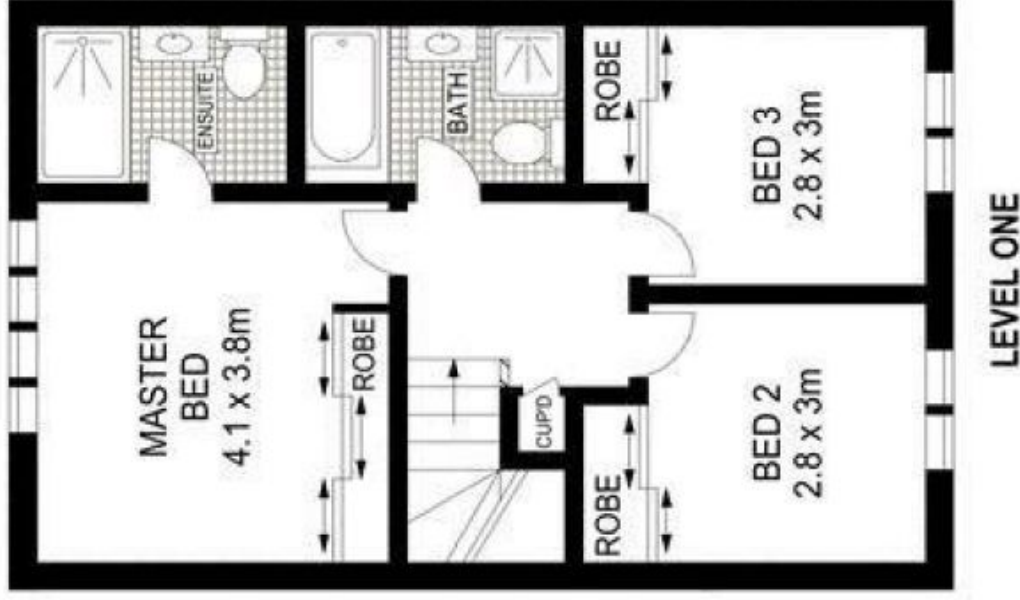
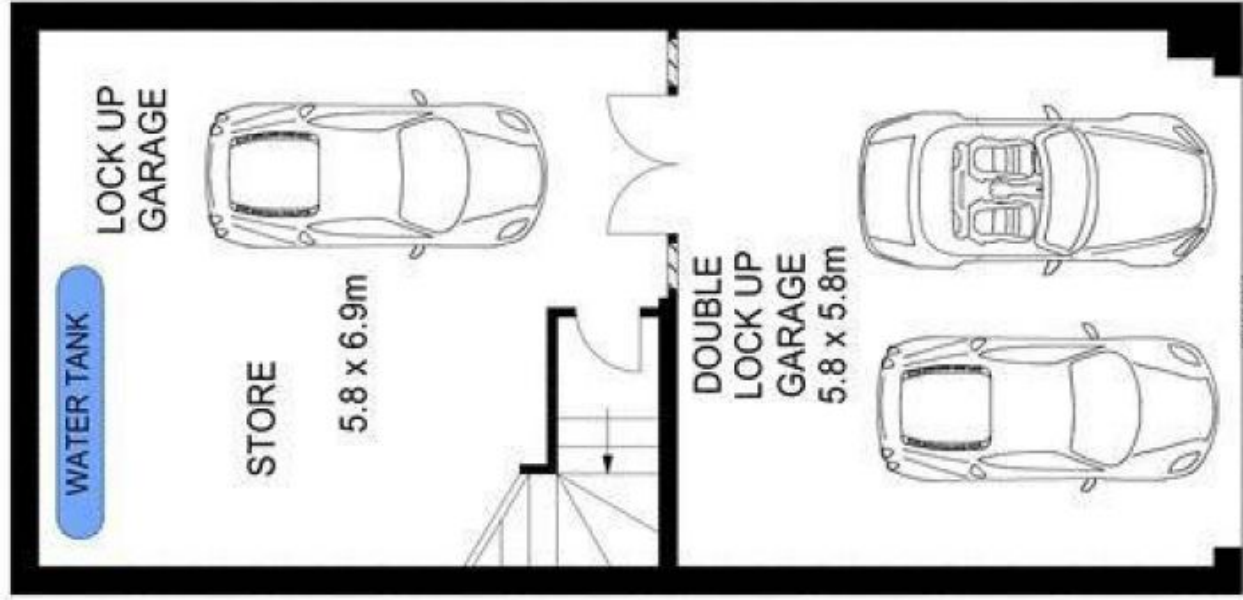

Scale in metres. Indicative only. Dimensions are approximate. All information contained herein is gathered from sources we believe to be reliable. However we cannot guarantee its accuracy and interested persons should rely on their own enquiries.